

Rapid COVID-19 Screening for Workplaces

Improve workplace safety & continuity during the pandemic with rapid testing and tracing for COVID-19

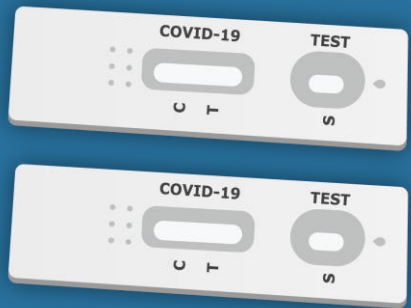

Rapid Test & Trace

Powered by



Protecting Your Workplace



A significant number of COVID-19 infections come from workplace transmission

PCR TESTING: EXPENSIVE & TIME-CONSUMING

\$\$

PCR testing options take up to 3 days to deliver results and cost up to \$200/test, which is long and costly for businesses

- **Detect COVID-19 in 15 minutes with rapid antigen screening**
 - Help stop the spread of COVID-19
 - Improve workplace safety
 - Keep your business open

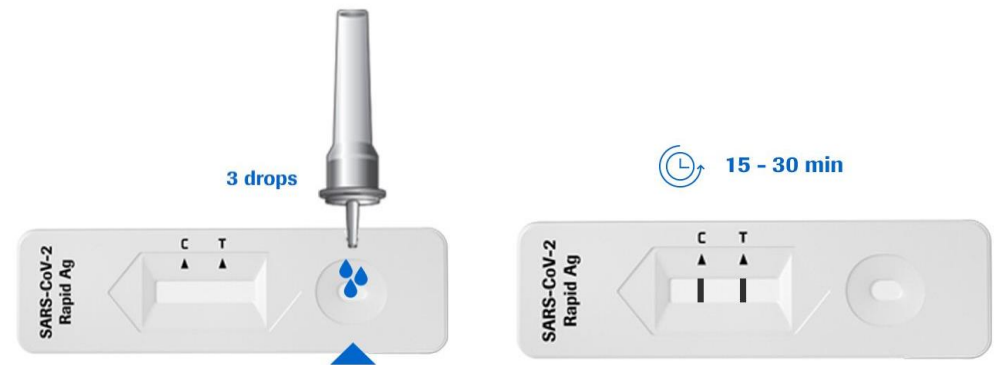

Rapid Antigen or PCR Test



Research indicates frequent, affordable antigen screening is more effective at detecting the virus during peak infectiousness than infrequent PCR testing

	PCR TEST	ANTIGEN SCREEN
OBJECTIVE OF TEST	To diagnose current COVID-19 infection by detecting the virus' RNA	To screen for COVID-19 by detecting protein fragments specific to virus
AVERAGE PROCESSING TIME	~1-2 business days	~15 minutes
AVERAGE PRICE/TEST	~\$200	~\$15-25
SENSITIVITY (TRUE POSITIVE RATE)	94%-100%	90%-96%
SPECIFICITY (TRUE NEGATIVE RATE)	93%-100%	92%-100%

Rapid Testing Advisory Services



Test Procurement

- Test selection and purchasing
- Logistics and distribution

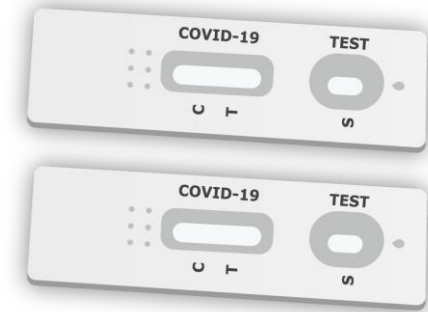

Program Planning

- Applying for tests from government stockpiles
- Administering testing programs for workforces, events & communities



Data Management

- Platform to provide data, privacy, and information management associated with rapid testing

Enhance Safety & Manage Risk



Companies

- Frequent testing to keep facilities in operation
- Avoid shutdowns and prevent lost revenue from outbreaks

Health Facilities

- Helps save lives
- Protect vulnerable citizens in hospitals or long-term care

Event & Hospitality

- Give patrons confidence
- Help concerts, travel and other activities reopen/operate safely

Educational Institutions

- Give security to staff, students and families
- Identify and isolate COVID-19 in schools and universities

Communities

- Stop the spread of COVID-19 with mass testing and contact tracing
- Allow residents to safely resume their lives without lockdowns

Data Management – WelTel Health



Function	WelTel digital technology platform features
Participant Engagement	<ul style="list-style-type: none">• Works on any mobile phone• Multilingual broadcast ability
Data Management	<ul style="list-style-type: none">• Seamless data import and export• Central data storage with easy visual reporting
Consent Management	<ul style="list-style-type: none">• Automated enrolment and consent at point of entry
Privacy & Security	<ul style="list-style-type: none">• Privacy by design, access restriction set by administrator• Compliance with international data privacy and protection standards

Named among best apps in Johns Hopkins' "Report On Top Digital Solutions for COVID-19 Response" for case management and contact tracing

Turnkey Workplace Program

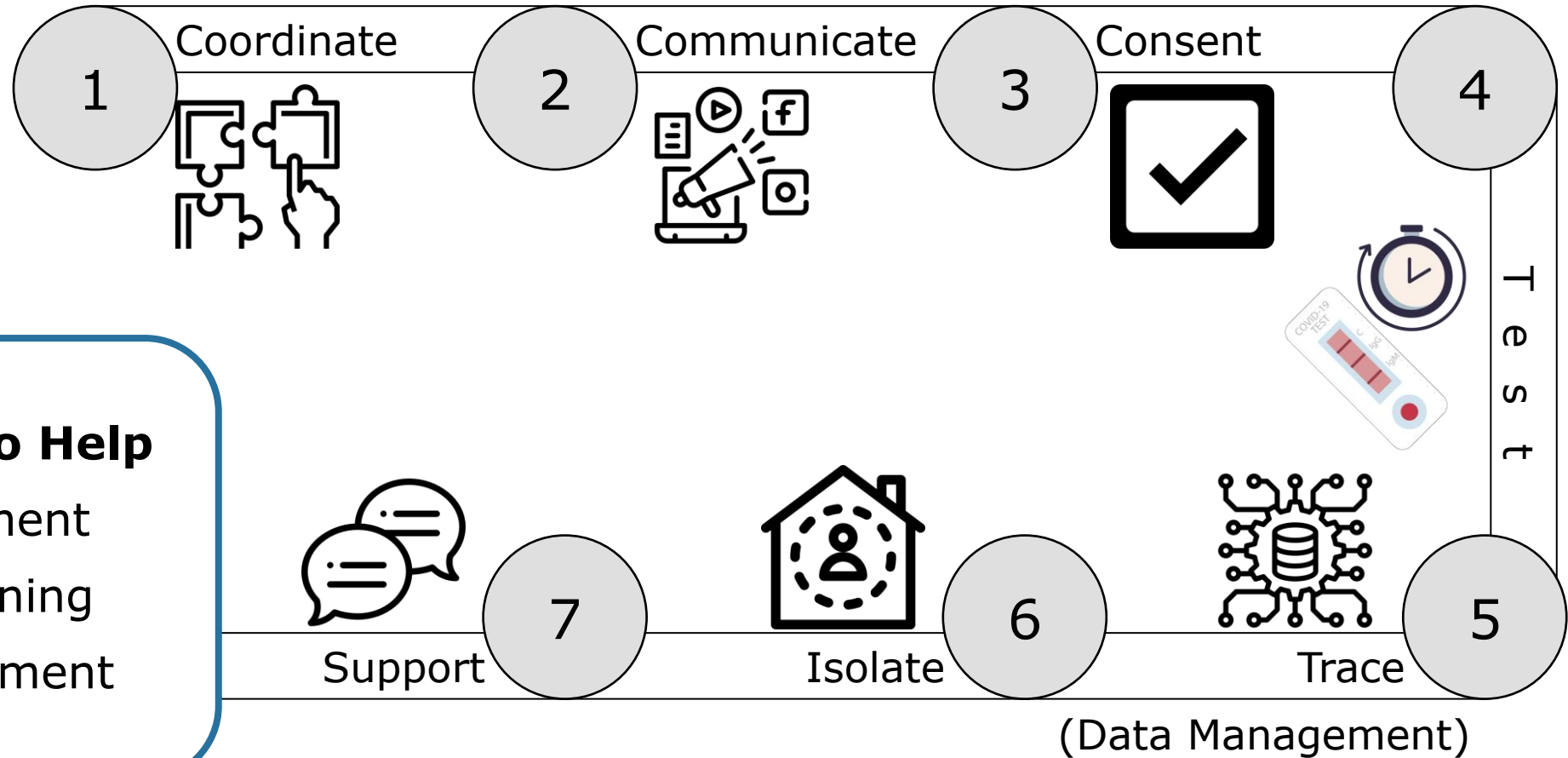
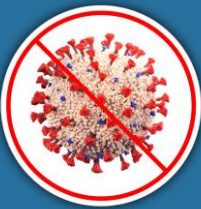

RTTC is Here to Help

- Test procurement
- Program planning
- Data management

Test Comparison



Test	Collection Method	Starting Price	Equipment Required	Sensitivity
Roche Rapid Antigen	Nasopharyngeal	\$15/test	No	96.52%
BTNX Rapid Antigen	Nasal	\$19/test	No	90.2%
FebriDX	Blood	\$30/test	No	91%
Spartan RT-PCR	Nasopharyngeal	\$80/test	Yes	83.9%
Precision RT-PCR	Nasopharyngeal	\$100/test	Yes	96.9%

Roche Rapid Antigen Test



Roche Diagnostics – SARS-CoV-2 Rapid Antigen Test

- Leading global manufacturer of diagnostic tests
- Health Canada authorized COVID-19 rapid antigen test
- Results in as little as 15 minutes
- 96.52% test sensitivity
- Dry storage at normal room temperatures
- Recommended frequency: all staff test twice weekly

Test QTY Cost per Test

5,000	\$18.50
50,000	\$16.50
100,000	\$15.00
100,000+	Contact us

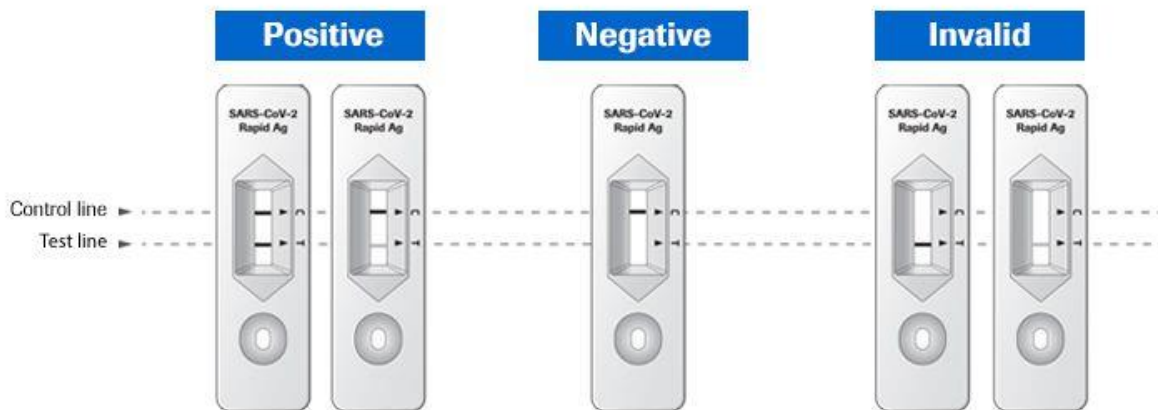

BTNX Rapid Antigen Test



BTNX – Rapid Response™ COVID-19 Antigen Rapid Test Device

- Health Canada authorized COVID-19 rapid antigen test
- Results in as little as 15 minutes
- 90.2% test sensitivity
- Dry storage at normal room temperatures
- Recommended frequency: all staff test twice weekly

Test QTY

Cost per Test

5,000

\$22.50

50,000

\$21.50

100,000

\$19.00

100,000+

Contact us

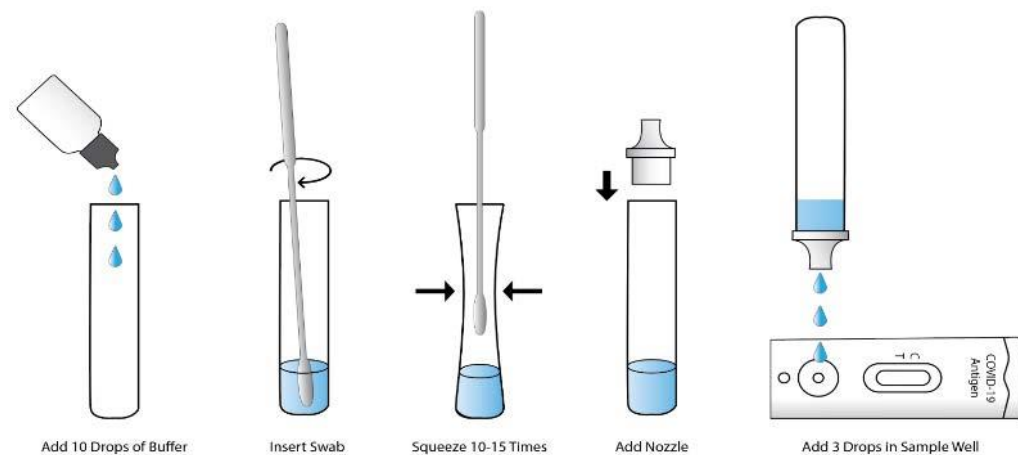

FebriDX[®] Rapid Test



Northern Diagnostics – FebriDX[®] Rapid Test

- Health Canada authorized test to identify and differentiate viral from bacterial acute respiratory infection
 - use for the specific diagnosis of COVID-19 is not authorized by Health Canada
- Results in as little as 10 minutes
- 91% test sensitivity
- Dry storage at normal room temperatures
- Recommended frequency: all staff test twice weekly



Lance Finger



Collect Blood

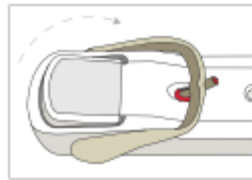

Deliver Blood

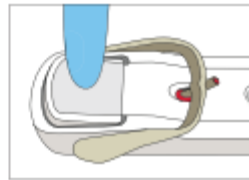

Deliver Buffer

Test QTY

Cost per Test

5,000

\$40.00

50,000

\$35.00

100,000

\$30.00

100,000+

Contact us

FebriDX[®]



Rapid Test  Trace Powered by 

Spartan Mobile Rapid PCR



Spartan Bioscience – COVID-19 Test System

- Health Canada authorized COVID-19 RT-PCR test
- Results in 1 hour
- 83.9% test sensitivity
- Dry storage at normal room temperatures
- Offers the speed and ease of use of a rapid test, while using the technology of lab-based COVID-19 testing solutions

Test QTY	Cost per Test
----------	---------------

Starting at	\$80.00
-------------	---------

Equipment: \$8,000-\$10,000



Spartan

System Includes

- The Spartan Cube®
- Laptop
- Barcode scanner
- Specimen Tube
- Sample Preparation Kit
- Test Cartridge

Rapid Test  Trace Powered by 

Precision Mobile Rapid PCR

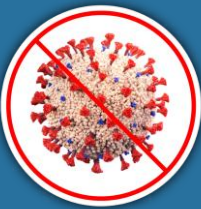

Precision Biomonitoring – Biomeme Franklin Three9 portable testing device

- Health Canada authorized COVID-19 RT-PCR test
- Results in 65 minutes
- 96.9% test sensitivity
- Weighs less than 3lbs and can run on a battery for up to 5 hours
- Authorized for use by licensed healthcare professionals only

Test QTY	Cost per Test
----------	---------------

600	\$100
-----	-------

Equipment: \$28,000



About Rapid Test & Trace Canada (RTTC)



- Who:** Coalition of leading infectious disease specialists, public health professionals, academics and businesses
- Where:** Across Canada, with international advisers
- How:** Working in partnership with Canadian businesses: testing, tracing, hospitality, cultural and entertainment
- Why:** **Stop the spread of COVID-19** through collaborative efforts:
- Rapid testing technology
 - Evidence-based digital data management and integration
 - Follow-up communication and support
- What:** Rapid testing and tracing program solutions customized to your business

RTTC in the News



Open letter advocating for widespread rapid testing

- Co-authored with the Canadian Chamber of Commerce
- 28 members of the medical and business communities

NATIONAL POST

Banff Test & Trace Pilot Project

- Municipality-wide pilot in final planning stages
- Aims to test all residents twice a week

Global

Thank you



Contact Information

sandy@rapidtesttrace.ca

www.rapidtestandtrace.ca